

ENGINES / AMGEV 90

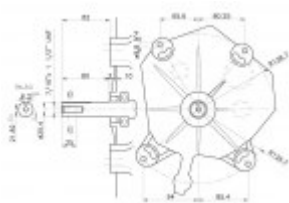

The vertical shaft configuration of the 13 hp AMGEV 90 engine is more suitable for several special applications, both for professional use and at home in the garden: small tractors and mowers, just to name a few.

MODEL	AMGEV 90
ENGINE TYPE	OHV single cylinder engine, Vertical shaft, air cooling, air-cooled, 4-stroke
POWER (Hp/Kw)	13 / 9.6
DISPLACEMENT (cc)	419.7
RPM	3600
BORE/STROKE RATIO (mm)	90x66
COMPRESSION RATIO	8.5:1
STARTING	Electric / Manual
FUEL TYPE	Unleaded petrol
FUEL TANK CAPACITY (litres)	--
OIL	SAE 10W 40 SJ Multi-grade
OIL PAN CAPACITY (litres)	6.5
AIR FILTER	Dry
OVERALL DIMENSIONS (mm)	470 x 420 x 435
DRY WEIGHT (Kg)	29



AVAILABLE VARIANTS

AMGEV 90 F15 Cylindrical shaft Ø 25.4 mm x 82 mm, Electric Start

<http://www.axo-group.com/en/products/engines/amgev-90.php>

AXO GROUP SRL - Via Spallanzani, 15 - 42024 Castelnovo di Sotto (RE)
Partita IVA, Codice Fiscale IT 02342860356 - Tel: 0522 688175 Fax: 0522 483731