

ENGINES / AMGV 68

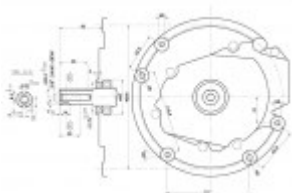

The smooth vertical shaft with key way cut configuration make this model, with a 5 hp petrol engine, suitable for both professional applications as well as for home landscaping and hobbies (mower, sweeper, chipper).

MODEL	AMGV 68
ENGINE TYPE	OHV single cylinder engine, Vertical shaft, air cooling, air-cooled, 4-stroke
POWER (Hp/Kw)	5 / 3,7
DISPLACEMENT (cc)	159
RPM	3600
BORE/STROKE RATIO (mm)	65x48
COMPRESSION RATIO	8:1
STARTING	Recoil start
ENGINE REGIME	Fixed
FUEL TYPE	Unleaded petrol
FUEL TANK CAPACITY (litres)	0.9
OIL	SAE 10W 40 SJ Multi-grade
OIL PAN CAPACITY (litres)	0.55
AIR FILTER	Dry
OVERALL DIMENSIONS (mm)	371 x 338 x 337
DRY WEIGHT (Kg)	11



AVAILABLE VARIANTS

AMGV 68 F8	Albero cilindrico Ø 22,2 mm x 62 mm
------------	-------------------------------------

<http://www.axo-group.com/en/products/engines/amgv-68.php>

AXO GROUP SRL - Via Spallanzani, 15 - 42024 Castelnovo di Sotto (RE)
Partita IVA, Codice Fiscale IT 02342860356 - Tel: 0522 688175 Fax: 0522 483731